

Memorandum of Agreement, Made this...14th.....

day of February....A. D., 1927., by and between M. P. MOLLER, Inc., of Hagerstown, Maryland, party of the first part, and

First Congregational Church.....
of the second part.

Witnesseth: That the party of the first part hereby agrees to build an organ after and according to the annexed specifications and plans to be hereafter approved by party of second part, and to erect it in...First Congregational Church, Clinton, Michigan
.....
ready for use on or before the 1st.....day of September.....A. D., 1927., or as soon thereafter as possible in the event of delays beyond his control.

2. The party of the first part agrees that the organ when completed shall be first class, free from defects in material or workmanship, and that the party of the second part may have it examined, immediately on completion, in the presence of representative of first party, by a competent and disinterested expert, and if said examination shows that the organ does not conform with this agreement the party of the first part agrees to remedy defects at his own expense.

3. The party of the first part guarantees the action and construction of the organ for a term of ~~one~~ **five** year from date of completion and agrees to correct defects in material or workmanship that may be brought to his attention within that time, without cost to the party of the second part. This does not include tuning or ordinary care of the organ (or electric motors which are guaranteed by the manufacturers for one year).

4. In consideration of the above, the party of the second part agrees to pay M. P. Moller, Inc., or order, the sum of...Four thousand five hundred fifty dollars.....
.....(\$4,550.00).....

AS FOLLOWS: \$3000.00 when organ is installed and accepted. Balance in two equal notes due one and two years from date of installation and bearing interest at 6%. The purchaser has the privilege of paying more than \$3000.00 when organ is accepted or of paying notes anytime in advance of date due.....

5. The party of the second part also agrees that the building will be in proper condition for the installation of the organ...four.....weeks previous to date of completion; that they will allow, free from interruption, suitable convenience and opportunity for the installation in the building, provide such a condition of quiet as is necessary for the proper tone regulation and tuning of the instrument, and necessary light, heat and power.

6. The party of the second part also agrees to insure the organ or its parts against loss by fire, water, etc., as soon as the parts are placed in the building, for the benefit of the parties hereto, as their interests may appear.

MAR 14 1927

No. 2

7. When electric motor is included in specifications, party of the second part agrees to provide foundation and enclosures when necessary; to furnish and install all wind conductor between blower and organ; to do all wiring connected therewith; to install such lights as may be needed for the erection and future care of the organ, and do any necessary cutting of floors, partitions, or other parts of the building. In the event that automatic remote control motor starter, electrical conduits or other special equipment are required they are to be furnished by party of second part.

8. ~~When organ chambers are so located that organ must be hoisted by skids, block and tackle or other mechanical means the necessary apparatus is to be furnished by party of second part.~~

9. It is mutually agreed that the title and ownership of the organ shall remain with party of the first part until the contract price, before mentioned, has been fully paid, after which the instrument shall become the property of the party of the second part; also that all verbal agreements and understandings are merged in this contract, and the specifications and details of construction attached hereto.

In Witness Whereof we have hereunto set our hands and seals this day and year first above written.

WITNESS

.....(SEAL)
Party of the first part

..... H. R. House..... First Congregational Church..(SEAL)

..... C. L. House..... C. L. Kimball.....(SEAL)
Charm. Organ Comm.
.....(SEAL)

.....(SEAL)
Party of the second part

Ford & Reynolds

NOTE—If terms other than “cash on completion” are desired they can be arranged for before contract is signed. All deferred payments to be secured by notes signed by church trustees and bear interest at 6% from date.

M. P. MÖLLER Organ Factory

Pipe Organ No. 4942 Date Feb. 14, 1927
 For First Congregational Church, Clinton, Mich.,
 Action Elec. Console Detached 10'
 Casing No. Natural Oak Finish
 Decorations Motor Elec.
 Width of Key-bed Stop Controls Stop Keys
 No. Manuals Two Wind Pressure 5"
 To be completed Sept. 1, 1927 Blower pipe furnished by Church

A-440

SPECIFICATIONS

Organ chamber by church. No casing to be used
 Factory to place switch for starting motor on cheek of
 organ under console cover. Grille by Organ Factory

GREAT ORGAN 73 Chest

1	8'	Open Diapason....44 scale.....	61 Pipes
2	8'	Dulciana.....	73 Pipes
3	8'	Rohr Flute.....from #8.....	73 Notes
4	8'	Clarabella.....melodia scale....	73 Pipes
5	8'	Soft String.....from #10.....	73 Notes
6	4'	Flute d'Amour...from #8.....	73 "
7	4'	Chimes.....	20 Bells
		<i>Principal</i>	<i>61 Notes</i>

SWELL ORGAN

8	16'	Bourdon.....unit.....	97 Pipes
9	8'	Stopped Diapason...from #8.....	73 Notes
10	8'	Salicional.....	73 Pipes
11	4'	Flute Traverso.....from #4.....	61 Notes
12	2'	Piccolo.....from #8.....	61 "
13	8'	Dolce..(<i>almost</i> Aeoline) from #2...	73 "
14	8'	Oboe.....	73 Pipes
15	8'	Vox Celeste....Tenor C	61 "
16	8'	Vox Humana.....S.S.B.....	61 "
		<i>Violin Diap.</i>	<i>73 "</i>

PEDAL ORGAN

17	16'	Bourdon....Large scale.....	32 Pipes
18	16'	Lieblich Gedeckt...from #8.....	32 Notes

COUPLERS

19	Great to Great 4'	25	Swell to Swell 16'
20	Great to Great 16'	26	Swell to Pedal
21	Swell to Great 4'	27	Great to Pedal
22	Swell to Great 8'	28	Swell Unison Off
23	Swell to Great 16'	29	Great Unison Off
24	Swell to Swell 4'		

MECHANICALS

30	Tremulant
	Crescendo Indicator
	Wind Indicator

ADJUSTABLE COMBINATIONS

(Operated by pistons placed under respective manuals)

Pistons (1) (2) (3) (4)	Affecting Swell & Pedal Stops
Pistons (1) (2) (3) (4)	Affecting Great & Pedal Stops

M. P. MÖLLER Organ Factory

4942

Pipe Organ No. 4942 Date Feb. 14, 1927
 For First Congregational Church, Clinton, Mich.,
 Action Elec. Console Detached 10'
 Casing No. Natural Oak Finish
 Decorations Motor Elec.
 Width of Key-bed Stop Controls Stop Keys
 No. Manuals Two Wind Pressure 5"
 To be completed Sept. 1, 1927 Church
 Blower pipe furnished by

A-440

SPECIFICATIONS

Organ chamber by church. No casing to be used
 Factory to place switch for starting motor on cheek of
 organ under console cover. Grille by Organ Factory

GREAT ORGAN 73 Chest

1	8'	Open Diapason....44 scale.....	61 Pipes
2	8'	Dulciana.....	73 Pipes
3	8'	Rohr Flute.....from #8.....	73 Notes
4	8'	Clarabella.....melodia scale.....	73 Pipes
5	8'	Soft String.....from #10.....	73 Notes
6	4'	Flute d'Amour...from #8.....	73 "
7		Chimes.....	20 Bells
	4'	Principal.....	61 notes

SWELL ORGAN

8	16'	Bourdon.....unit.....	97 Pipes
9	8'	Stopped Diapason...from #8.....	73 Notes
10	8'	Salicional.....	73 Pipes
11	4'	Flute Traverso....from #4.....	61 Notes
12	2'	Piccolo.....from #8.....	61 "
13	8'	Dolce..(Almost Aeoline) from #2..	73 "
14	8'	Oboe.....	73 Pipes
15	8'	Vox Celeste....Tenor C	61 "
16	8'	Vox Humana.....S.S.B.....	61 "

PEDAL ORGAN

17	16'	Bourdon....Large scale.....	32 Pipes
18	16'	Lieblich Gedeckt...from #8.....	32 Notes

COUPLERS

19	Great to Great 4'	25	Swell to Swell 16'
20	Great to Great 16'	26	Swell to Pedal
21	Swell to Great 4'	27	Great to Pedal
22	Swell to Great 8'	28	Swell Unison Off
23	Swell to Great 16'	29	Great Unison Off
24	Swell to Swell 4'		

MECHANICALS

30	Tremulant
	Crescendo Indicator
	Wind Indicator

ADJUSTABLE COMBINATIONS

(Operated by pistons placed under respective manuals)

Pistons (1) (2) (3) (4)	Affecting Swell & Pedal Stops
Pistons (1) (2) (3) (4)	Affecting Great & Pedal Stops

M. P. MÖLLER ORGAN WORKS

HAGERSTOWN, MD.

Organ No. 4942 Contract Rec'd Feb. 14, 1927 To be Completed Sept. 1, 1927
Name of First Congregational Church Street No. _____
City Clinton State Mich. County _____
Address Correspondence to Mr. C. L. Kimball Street No. _____
Ship Organ to _____ Freight Station _____
Route Organ Via P.R.R. c/i N.Y.C. at Erie Request of _____
Railroads on which located and rates { N.Y.C. 1175.101 1/2
Wrote _____ For Freight Station _____ O. K. _____

No casing.

CASING AND DISPLAY PIPES

Casing console made of Natural Oak Sample to Kimball 4/15/27
Grille made of Yes grille Trifle darker
Front pipes decorated in None O. K. _____
Wrote 7/18/27 For sample of wood and decorations 3/14/27

ELECTRIC MOTOR AND BLOWER

10"

Blue print, showing size blower sent to _____ Date _____ Approved _____
Motor Elec. Date Spec. sent to Kinetic for size of motor March 4, 1927
Kinetic advise us of 1 1/2 H. P. motor. Cond. pipe furnished by Church
Date blower ordered 5/4/27 To reach destination Aug 1, 1927 Date shipped 7/11/27
Electric Current { A.C. } 200 1/2 Phase Single Cycles 60 Volts 115
Wrote 7/18/27 to have Electric blank filled up 3/19/27 O. K. _____

REED PIPES

Reeds ordered from See cont. Boston Date ordered 5/5/27 Pitch A-440
Date to reach destination Aug 1, 1927 Wind Pressure 5" Date shipped 7/18/27

OTHER INFORMATION

Action of Organ Elec. Stops controlled by Stop Keys
Organ to be voiced on 5" No. Manuals 2 No. Stops 30
Organ shipped 7/5/27 Is church old or new Old
Do we get any old Organ None To be shipped to _____
NO. 4942 PLACE CLINTON, MICH.

FORD

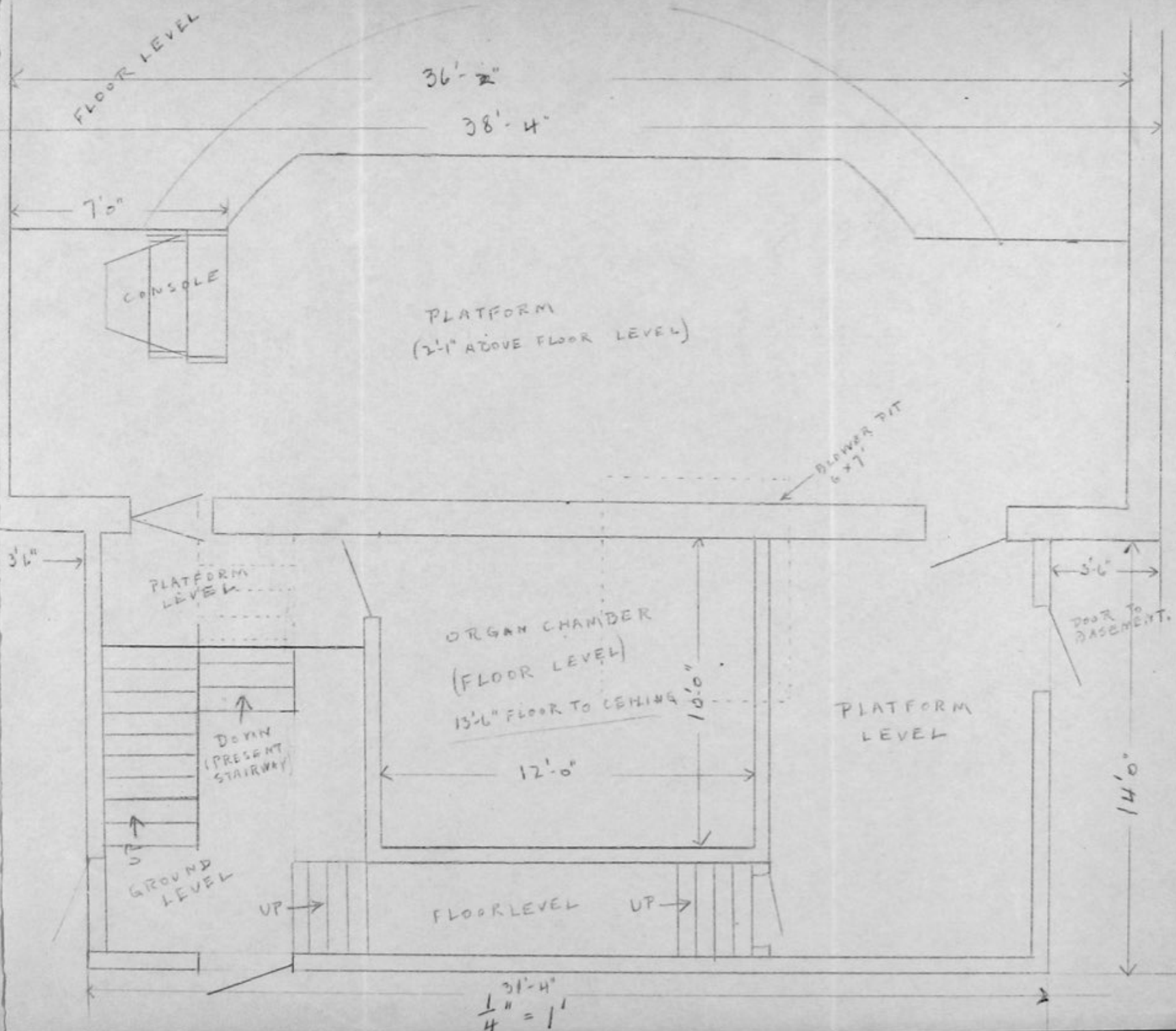

Hagerstown, Md., March 4, 1937

494 2

Clinton, Mich., #4942.

#30 Stop Keys white engraved in black block letters.

Open Diapason 8'	Dulciani 8'	Mohr Flute 8'
Clarabella 8'	Soft String 8'	Flute D'Amour 4'
Bourdon 16'	Stopped Diapason 8'	Solicional 8'
Flute Traverso 4'	Piccolo 2'	Dolce 8'
Oboe 8'	Vox Celeste 8'	Vox Humana 8'
Bourdon 16'	Lieblich Gedeckt 16'	Swell to Great
Swell to Pedal	Great to Pedal	

#30 Stop Keys white engraved in red block letters.

Chimes	Great to Great 4'	Great to Great 16'
Swell to Great 4'	Swell to Great 16'	Swell to Swell 4'
Swell to Swell 16'	Swell Unison Separation	
Great Unison Separation	Tremulant	